

Form No. S16-I
表格第 S16-I 號

This document is received on 2026-03-25
The Town Planning Board will formally acknowledge
the date of receipt of the application only upon receipt
of all the required information and documents.

**APPLICATION FOR PERMISSION
UNDER SECTION 16 OF
THE TOWN PLANNING ORDINANCE
(CAP. 131)**

根據《城市規劃條例》(第131章)
第16條遞交的許可申請

Applicable to proposals not involving or not only involving:
適用於建議不涉及或不祇涉及:

- (i) **Construction of “New Territories Exempted House(s)”;**
興建「新界豁免管制屋宇」;
- (ii) **Temporary use/development of land and/or building not exceeding 3 years in rural areas or Regulated Areas; and**
位於鄉郊地區或受規管地區土地上及/或建築物內進行為期不超過三年的臨時用途/發展;及
- (iii) **Renewal of permission for temporary use or development in rural areas or Regulated Areas**
位於鄉郊地區或受規管地區的臨時用途或發展的許可續期

Applicant who would like to publish the notice of application in local newspapers to meet one of the Town Planning Board’s requirements of taking reasonable steps to obtain consent of or give notification to the current land owner, please refer to the following link regarding publishing the notice in the designated newspapers:
https://www.tpb.gov.hk/en/plan_application/apply.html

申請人如欲在本地報章刊登申請通知，以採取城市規劃委員會就取得現行土地擁有人的同意或通知現行土地擁有人所指定的其中一項合理步驟，請瀏覽以下網址有關在指定的報章刊登通知：
https://www.tpb.gov.hk/tc/plan_application/apply.html

General Note and Annotation for the Form
填寫表格的一般指引及註解

“Current land owner” means any person whose name is registered in the Land Registry as that of an owner of the land to which the application relates, as at 6 weeks before the application is made
「現行土地擁有人」指在提出申請前六星期，其姓名或名稱已在土地註冊處註冊為該申請所關乎的土地的擁有人的人

& Please attach documentary proof 請夾附證明文件

^ Please insert number where appropriate 請在適當地方註明編號

Please fill “NA” for inapplicable item 請在不適用的項目填寫「不適用」

Please use separate sheets if the space provided is insufficient 如所提供的空間不足，請另頁說明

Please insert a 「✓」 at the appropriate box 請在適當的方格內上加上「✓」號

2600535

2026.3.4 By Post

Form No. S16-I 表格第 S16-I 號

For Official Use Only 請勿填寫此欄	Application No. 申請編號	A/TU- TT / 779
	Date Received 收到日期	2026 -03- 25

- The completed form and supporting documents (if any) should be sent to the Secretary, Town Planning Board (the Board), 15/F, North Point Government Offices, 333 Java Road, North Point, Hong Kong.
申請人須把填妥的申請表格及其他支持申請的文件 (倘有), 送交香港北角渣華道 333 號北角政府合署 15 樓城市規劃委員會(下稱「委員會」)秘書收。
- Please read the "Guidance Notes" carefully before you fill in this form. The document can be downloaded from the Board's website at <http://www.tpb.gov.hk/>. It can also be obtained from the Secretariat of the Board at 15/F, North Point Government Offices, 333 Java Road, North Point, Hong Kong (Tel: 2231 4810 or 2231 4835), and the Planning Enquiry Counters of the Planning Department (Hotline: 2231 5000) (17/F, North Point Government Offices, 333 Java Road, North Point, Hong Kong and 14/F, Sha Tin Government Offices, 1 Sheung Wo Che Road, Sha Tin, New Territories).
請先細閱《申請須知》的資料單張, 然後填寫此表格。該份文件可從委員會的網頁下載 (網址: <http://www.tpb.gov.hk/>), 亦可向委員會秘書處 (香港北角渣華道 333 號北角政府合署 15 樓 - 電話: 2231 4810 或 2231 4835) 及規劃署的規劃資料查詢處 (熱線: 2231 5000) (香港北角渣華道 333 號北角政府合署 17 樓及新界沙田上禾輦路 1 號沙田政府合署 14 樓) 索取。
- This form can be downloaded from the Board's website, and obtained from the Secretariat of the Board and the Planning Enquiry Counters of the Planning Department. The form should be typed or completed in block letters. The processing of the application may be refused if the required information or the required copies are incomplete.
此表格可從委員會的網頁下載, 亦可向委員會秘書處及規劃署的規劃資料查詢處索取。申請人須以打印方式或以正楷填寫表格。如果申請人所提交的資料或文件副本不齊全, 委員會可拒絕處理有關申請。

1. Name of Applicant 申請人姓名/名稱	
<input checked="" type="checkbox"/> Mr. 先生 / <input type="checkbox"/> Mrs. 夫人 / <input type="checkbox"/> Miss 小姐 / <input type="checkbox"/> Ms. 女士 / <input type="checkbox"/> Company 公司 / <input type="checkbox"/> Organisation 機構	
Lo Yuk Lam 盧育林 Zeng Xuan 曾玄	
2. Name of Authorised Agent (if applicable) 獲授權代理人姓名/名稱 (如適用)	
<input checked="" type="checkbox"/> Mr. 先生 / <input type="checkbox"/> Mrs. 夫人 / <input type="checkbox"/> Miss 小姐 / <input type="checkbox"/> Ms. 女士 / <input type="checkbox"/> Company 公司 / <input type="checkbox"/> Organisation 機構	
TANG LOK SAN 鄧樂桑	
3. Application Site 申請地點	
(a) Full address / location / demarcation district and lot number (if applicable) 詳細地址/地點/丈量約份及地段號碼 (如適用)	Lot 2309 S.A (Part) in D.D. 118, Tai Tong, Yuen Long
(b) Site area and/or gross floor area involved 涉及的地盤面積及/或總樓面面積	<input checked="" type="checkbox"/> Site area 地盤面積 245 sq.m 平方米 <input checked="" type="checkbox"/> About 約 <input checked="" type="checkbox"/> Gross floor area 總樓面面積 38.4 sq.m 平方米 <input checked="" type="checkbox"/> About 約
(c) Area of Government land included (if any) 所包括的政府土地面積 (倘有) NA 不適用 sq.m 平方米 <input type="checkbox"/> About 約

(d) Name and number of the related statutory plan(s) 有關法定圖則的名稱及編號	大棠分區計劃大綱核准圖編號 S/YL-TT/20 APPROVED TAI TONG OUTLINE ZONING PLAN NO. S/YL-TT/20
(e) Land use zone(s) involved 涉及的土地用途地帶	「農業」 "Agriculture"
(f) Current use(s) 現時用途	空置 Vacant (If there are any Government, institution or community facilities, please illustrate on plan and specify the use and gross floor area) (如有任何政府、機構或社區設施，請在圖則上顯示，並註明用途及總樓面面積)

4. "Current Land Owner" of Application Site 申請地點的「現行土地擁有人」

The applicant 申請人 –

- is the sole "current land owner" #& (please proceed to Part 6 and attach documentary proof of ownership).
是唯一的「現行土地擁有人」 #& (請繼續填寫第 6 部分，並夾附業權證明文件)。
- is one of the "current land owners" #& (please attach documentary proof of ownership).
是其中一名「現行土地擁有人」 #& (請夾附業權證明文件)。
- is not a "current land owner" #.
並不是「現行土地擁有人」 #。

- The application site is entirely on Government land (please proceed to Part 6).
申請地點完全位於政府土地上 (請繼續填寫第 6 部分)。

5. Statement on Owner's Consent/Notification 就土地擁有人的同意/通知土地擁有人的陳述

- (a) According to the record(s) of the Land Registry as at (DD/MM/YYYY), this application involves a total of "current land owner(s)" #.
根據土地註冊處截至 年 月 日的記錄，這宗申請共牽涉 名「現行土地擁有人」 #。

(b) The applicant 申請人 –

- has obtained consent(s) of "current land owner(s)" #.
已取得 名「現行土地擁有人」 # 的同意。

Details of consent of "current land owner(s)" # obtained 取得「現行土地擁有人」 # 同意的詳情		
No. of 'Current Land Owner(s)' 「現行土地擁有人」數目	Lot number/address of premises as shown in the record of the Land Registry where consent(s) has/have been obtained 根據土地註冊處記錄已獲得同意的地段號碼/處所地址	Date of consent obtained (DD/MM/YYYY) 取得同意的日期 (日/月/年)

(Please use separate sheets if the space of any box above is insufficient. 如上列任何方格的空間不足，請另頁說明)

- has notified “current land owner(s)”#
已通知 名「現行土地擁有人」#。

Details of the “current land owner(s)”# notified 已獲通知「現行土地擁有人」#的詳細資料		
No. of ‘Current Land Owner(s)’ 「現行土地擁有人」數目	Lot number/address of premises as shown in the record of the Land Registry where notification(s) has/have been given 根據土地註冊處記錄已發出通知的地段號碼/處所地址	Date of notification given (DD/MM/YYYY) 通知日期(日/月/年)

(Please use separate sheets if the space of any box above is insufficient. 如上列任何方格的空間不足，請另頁說明)

- has taken reasonable steps to obtain consent of or give notification to owner(s):
已採取合理步驟以取得土地擁有人的同意或向該人發給通知。詳情如下：

Reasonable Steps to Obtain Consent of Owner(s) 取得土地擁有人的同意所採取的合理步驟

- sent request for consent to the “current land owner(s)” on _____ (DD/MM/YYYY)#&
於_____ (日/月/年)向每一名「現行土地擁有人」#郵遞要求同意書&

Reasonable Steps to Give Notification to Owner(s) 向土地擁有人發出通知所採取的合理步驟

- published notices in local newspapers on _____ (DD/MM/YYYY)&
於_____ (日/月/年)在指定報章就申請刊登一次通知&
- posted notice in a prominent position on or near application site/premises on _____ (DD/MM/YYYY)&
於_____ (日/月/年)在申請地點/申請處所或附近的顯明位置貼出關於該申請的通知&
- sent notice to relevant owners’ corporation(s)/owners’ committee(s)/mutual aid committee(s)/management office(s) or rural committee on _____ (DD/MM/YYYY)&
於_____ (日/月/年)把通知寄往相關的業主立案法團/業主委員會/互助委員會或管理處，或有關的鄉事委員會&

Others 其他

- others (please specify)
其他（請指明）
- _____
- _____
- _____
- _____

Note: May insert more than one 「✓」.
Information should be provided on the basis of each and every lot (if applicable) and premises (if any) in respect of the application.

註：可在多於一個方格內加上「✓」號
申請人須就申請涉及的每一地段（倘適用）及處所（倘有）分別提供資料

6. Type(s) of Application 申請類別

- Type (i) Change of use within existing building or part thereof
第(i)類 更改現有建築物或其部分內的用途
- Type (ii) Diversion of stream / excavation of land / filling of land / filling of pond as required under Notes of Statutory Plan(s)
第(ii)類 根據法定圖則《註釋》內所要求的河道改道／挖土／填土／填塘工程
- Type (iii) Public utility installation / Utility installation for private project
第(iii)類 公用事業設施裝置/私人發展計劃的公用設施裝置
- Type (iv) Minor relaxation of stated development restriction(s) as provided under Notes of Statutory Plan(s)
第(iv)類 略為放寬於法定圖則《註釋》內列明的發展限制
- Type (v) Use / development other than (i) to (iii) above
第(v)類 上述的(i)至(iii)項以外的用途／發展

Note 1: May insert more than one 「✓」.

註 1：可在多於一個方格內加上「✓」號

Note 2: For Development involving columbarium use, please complete the table in the Appendix.

註 2：如發展涉及靈灰安置所用途，請填妥於附件的表格。

(ii) For Type (ii) application 供第(ii)類申請			
(a) Total floor area involved 涉及的總樓面面積	sq.m 平方米		
(b) Proposed use(s)/development 擬議用途/發展	(If there are any Government, institution or community facilities, please illustrate on plan and specify the use and gross floor area) (如有任何政府、機構或社區設施，請在圖則上顯示，並註明用途及總樓面面積)		
(c) Number of storeys involved 涉及層數		Number of units involved 涉及單位數目	
(d) Proposed floor area 擬議樓面面積	Domestic part 住用部分	sq.m 平方米	<input type="checkbox"/> About 約
	Non-domestic part 非住用部分	sq.m 平方米	<input type="checkbox"/> About 約
	Total 總計	sq.m 平方米	<input type="checkbox"/> About 約
(e) Proposed uses of different floors (if applicable) 不同樓層的擬議用途(如適用) (Please use separate sheets if the space provided is insufficient) (如所提供的空間不足，請另頁說明)	Floor(s) 樓層	Current use(s) 現時用途	Proposed use(s) 擬議用途

(ii) For Type (ii) application 供第(ii)類申請	
(a) Operation involved 涉及工程	<p><input type="checkbox"/> Diversion of stream 河道改道</p> <p><input type="checkbox"/> Filling of pond 填塘 Area of filling 填塘面積 sq.m 平方米 <input type="checkbox"/> About 約 Depth of filling 填塘深度 m 米 <input type="checkbox"/> About 約</p> <p><input checked="" type="checkbox"/> Filling of land 填土 Area of filling 填土面積 76 sq.m 平方米 <input checked="" type="checkbox"/> About 約 Depth of filling 填土厚度 0.2 m 米 <input checked="" type="checkbox"/> About 約</p> <p><input type="checkbox"/> Excavation of land 挖土 Area of excavation 挖土面積 sq.m 平方米 <input type="checkbox"/> About 約 Depth of excavation 挖土深度 m 米 <input type="checkbox"/> About 約</p> <p>(Please indicate on site plan the boundary of concerned land/pond(s), and particulars of stream diversion, the extent of filling of land/pond(s) and/or excavation of land) (請用圖則顯示有關土地/池塘界線, 以及河道改道、填塘、填土及/或挖土的細節及/或範圍)</p>
(b) Intended use/development 有意進行的用途/發展	<p>擬議臨時康體文娛場所(休閒農場)連附屬設施及相關填土工程 (為期5年)</p> <p>Proposed Temporary Place of Recreation, Sports or Culture (Hobby Farm) with Ancillary Facilities and Associated Filling of Land for a period of 5 years</p>

(iii) For Type (iii) application 供第(iii)類申請													
(a) Nature and scale 性質及規模	<p><input type="checkbox"/> Public utility installation 公用事業設施裝置</p> <p><input type="checkbox"/> Utility installation for private project 私人發展計劃的公用設施裝置</p> <p>Please specify the type and number of utility to be provided as well as the dimensions of each building/structure, where appropriate 請註明有關裝置的性質及數量, 包括每座建築物/構築物(倘有)的長度、高度和闊度</p> <table border="1" style="width: 100%; border-collapse: collapse;"> <thead> <tr> <th style="width: 35%;">Name/type of installation 裝置名稱/種類</th> <th style="width: 15%;">Number of provision 數量</th> <th style="width: 50%;">Dimension of each installation/building/structure (m) (LxWxH) 每個裝置/建築物/構築物的尺寸(米) (長 x 闊 x 高)</th> </tr> </thead> <tbody> <tr> <td> </td> <td> </td> <td> </td> </tr> <tr> <td> </td> <td> </td> <td> </td> </tr> <tr> <td> </td> <td> </td> <td> </td> </tr> </tbody> </table> <p>(Please illustrate on plan the layout of the installation 請用圖則顯示裝置的布局)</p>	Name/type of installation 裝置名稱/種類	Number of provision 數量	Dimension of each installation/building/structure (m) (LxWxH) 每個裝置/建築物/構築物的尺寸(米) (長 x 闊 x 高)									
Name/type of installation 裝置名稱/種類	Number of provision 數量	Dimension of each installation/building/structure (m) (LxWxH) 每個裝置/建築物/構築物的尺寸(米) (長 x 闊 x 高)											

(iv) For Type (iv) application 供第(iv)類申請

- (a) Please specify the proposed minor relaxation of stated development restriction(s) and **also fill in the proposed use/development and development particulars in part (v) below** –
請列明擬議略為放寬的發展限制並填妥於第(v)部分的擬議用途/發展及發展細節 –

- Plot ratio restriction From 由 to 至
地積比率限制
- Gross floor area restriction From 由sq. m 平方米 to 至sq. m 平方米
總樓面面積限制
- Site coverage restriction From 由% to 至 %
上蓋面積限制
- Building height restriction From 由m 米 to 至 m 米
建築物高度限制
From 由 mPD 米 (主水平基準上) to 至mPD 米 (主水平基準上)
From 由 storeys 層 to 至 storeys 層
- Non-building area restriction From 由m to 至 m
非建築用地限制
- Others (please specify)
其他 (請註明)

(v) For Type (v) application 供第(v)類申請

(a) Proposed use(s)/development
擬議用途/發展

擬議臨時康體文娛場所(休閒農場)連附屬設施及相關填土工程 (為期5年)

Proposed Temporary Place of Recreation, Sports or Culture (Hobby Farm) with Ancillary Facilities and Associated Filling of Land for a period of 5 years

(Please illustrate the details of the proposal on a layout plan 請用平面圖說明建議詳情)

(b) Development Schedule 發展細節表

Proposed gross floor area (GFA) 擬議總樓面面積	38.4	sq.m 平方米	<input checked="" type="checkbox"/> About 約
Proposed plot ratio 擬議地積比率	0.16		<input checked="" type="checkbox"/> About 約
Proposed site coverage 擬議上蓋面積	7.8	%	<input checked="" type="checkbox"/> About 約
Proposed no. of blocks 擬議座數	1		
Proposed no. of storeys of each block 每座建築物的擬議層數	2	storeys 層	
	<input type="checkbox"/>	include 包括.....storeys of basements 層地庫	
	<input type="checkbox"/>	exclude 不包括.....storeys of basements 層地庫	
Proposed building height of each block 每座建築物的擬議高度	mPD 米(主水平基準上)	<input type="checkbox"/> About 約
	..Not Exceeding 7.....	m 米	<input type="checkbox"/> About 約

- Domestic part 住用部分
- GFA 總樓面面積 sq. m 平方米 About 約
- number of Units 單位數目
- average unit size 單位平均面積sq. m 平方米 About 約
- estimated number of residents 估計住客數目

- Non-domestic part 非住用部分 GFA 總樓面面積
- eating place 食肆 sq. m 平方米 About 約
- hotel 酒店 sq. m 平方米 About 約
- (please specify the number of rooms
請註明房間數目)
- office 辦公室 sq. m 平方米 About 約
- shop and services 商店及服務行業 sq. m 平方米 About 約

- Government, institution or community facilities (please specify the use(s) and concerned land
政府、機構或社區設施 area(s)/GFA(s) 請註明用途及有關的地面面積／總
樓面面積)
-
-
-

- other(s) 其他 (please specify the use(s) and concerned land
area(s)/GFA(s) 請註明用途及有關的地面面積／總
樓面面積)
- Farm Reception: GFA: About 6m x 3.2m = About 19.2 m²
- Ancillary Storage: GFA: About 6m x 3.2m = About 19.2 m²
-

- Open space 休憩用地 (please specify land area(s) 請註明地面面積)
- private open space 私人休憩用地 sq. m 平方米 Not less than 不少於
- public open space 公眾休憩用地 sq. m 平方米 Not less than 不少於

(c) Use(s) of different floors (if applicable) 各樓層的用途 (如適用)

[Block number] [座數]	[Floor(s)] [層數]	[Proposed use(s)] [擬議用途]
.....
.....
.....
.....
.....

(d) Proposed use(s) of uncovered area (if any) 露天地方 (倘有) 的擬議用途

Car Parking, Circulation Space and Farming

.....

.....

.....

.....

7. Anticipated Completion Time of the Development Proposal 擬議發展計劃的預計完成時間

Anticipated completion time (in month and year) of the development proposal (by phase (if any)) (e.g. June 2023)
擬議發展計劃預期完成的年份及月份 (分期 (倘有)) (例：2023 年 6 月)
(Separate anticipated completion times (in month and year) should be provided for the proposed public open space and Government, institution or community facilities (if any))
(申請人須就擬議的公眾休憩用地及政府、機構或社區設施 (倘有) 提供個別擬議完成的年份及月份)

May 2027

.....

.....

.....

.....

.....

8. Vehicular Access Arrangement of the Development Proposal 擬議發展計劃的行人通道安排

<p>Any vehicular access to the site/subject building? 是否有車路通往地盤／有關建築物？</p>	<p>Yes 是</p> <p>No 否</p>	<p><input checked="" type="checkbox"/> There is an existing access. (please indicate the street name, where appropriate) 有一條現有車路。(請註明車路名稱(如適用)) Tai Shue Ha Road East, turn to local track</p> <p><input type="checkbox"/> There is a proposed access. (please illustrate on plan and specify the width) 有一條擬議車路。(請在圖則顯示，並註明車路的闊度)</p> <p><input type="checkbox"/></p>
<p>Any provision of parking space for the proposed use(s)? 是否有為擬議用途提供停車位？</p>	<p>Yes 是</p> <p>No 否</p>	<p><input checked="" type="checkbox"/> (Please specify type(s) and number(s) and illustrate on plan) 請註明種類及數目並於圖則上顯示</p> <p>Private Car Parking Spaces 私家車車位 <u>1</u></p> <p>Motorcycle Parking Spaces 電單車車位 _____</p> <p>Light Goods Vehicle Parking Spaces 輕型貨車泊車位 _____</p> <p>Medium Goods Vehicle Parking Spaces 中型貨車泊車位 _____</p> <p>Heavy Goods Vehicle Parking Spaces 重型貨車泊車位 _____</p> <p>Others (Please Specify) 其他 (請列明) _____</p> <p>_____</p> <p>_____</p>
<p>Any provision of loading/unloading space for the proposed use(s)? 是否有為擬議用途提供上落客貨車位？</p>	<p>Yes 是</p> <p>No 否</p>	<p><input type="checkbox"/> (Please specify type(s) and number(s) and illustrate on plan) 請註明種類及數目並於圖則上顯示</p> <p>Taxi Spaces 的士車位 _____</p> <p>Coach Spaces 旅遊巴車位 _____</p> <p>Light Goods Vehicle Spaces 輕型貨車車位 _____</p> <p>Medium Goods Vehicle Spaces 中型貨車車位 _____</p> <p>Heavy Goods Vehicle Spaces 重型貨車車位 _____</p> <p>Others (Please Specify) 其他 (請列明) _____</p> <p>_____</p> <p>_____</p> <p><input checked="" type="checkbox"/></p>

11. Declaration 聲明

I hereby declare that the particulars given in this application are correct and true to the best of my knowledge and belief.
本人謹此聲明，本人就這宗申請提交的資料，據本人所知及所信，均屬真實無誤。

I hereby grant a permission to the Board to copy all the materials submitted in this application and/or to upload such materials to the Board's website for browsing and downloading by the public free-of-charge at the Board's discretion. 本人現准許委員會酌情將本人就此申請所提交的所有資料複製及/或上載至委員會網站，供公眾免費瀏覽或下載。

Signature
簽署

Applicant 申請人 / Authorised Agent 獲授權代理人

.....
TANG LOK SAN

NA 不適用

Name in Block Letters
姓名 (請以正楷填寫)

Position (if applicable)
職位 (如適用)

Professional Qualification(s)
專業資格

Member 會員 / Fellow of 資深會員

HKIP 香港規劃師學會 /

HKIA 香港建築師學會 /

HKIS 香港測量師學會 /

HKIE 香港工程師學會 /

HKILA 香港園境師學會 /

HKIUD 香港城市設計學會

RPP 註冊專業規劃師

Others 其他

on behalf of
代表

Company 公司 / Organisation Name and Chop (if applicable) 機構名稱及蓋章 (如適用)

Date 日期

16/02/2026

(DD/MM/YYYY 日/月/年)

Remark 備註

The materials submitted in this application and the Board's decision on the application would be disclosed to the public. Such materials would also be uploaded to the Board's website for browsing and free downloading by the public where the Board considers appropriate.

委員會會向公眾披露申請人所遞交的申請資料和委員會對申請所作的決定。在委員會認為合適的情況下，有關申請資料亦會上載至委員會網頁供公眾免費瀏覽及下載。

Warning 警告

Any person who knowingly or wilfully makes any statement or furnish any information in connection with this application, which is false in any material particular, shall be liable to an offence under the Crimes Ordinance.

任何人在明知或故意的情況下，就這宗申請提出在任何要項上是虛假的陳述或資料，即屬違反《刑事罪行條例》。

Statement on Personal Data 個人資料的聲明

1. The personal data submitted to the Board in this application will be used by the Secretary of the Board and Government departments for the following purposes:

委員會就這宗申請所收到的個人資料會交給委員會秘書及政府部門，以根據《城市規劃條例》及相關的城市規劃委員會規劃指引的規定作以下用途：

(a) the processing of this application which includes making available the name of the applicant for public inspection when making available this application for public inspection; and

處理這宗申請，包括公布這宗申請供公眾查閱，同時公布申請人的姓名供公眾查閱；以及

(b) facilitating communication between the applicant and the Secretary of the Board/Government departments.

方便申請人與委員會秘書及政府部門之間進行聯絡。

2. The personal data provided by the applicant in this application may also be disclosed to other persons for the purposes mentioned in paragraph 1 above.

申請人就這宗申請提供的個人資料，或亦會向其他人士披露，以作上述第 1 段提及的用途。

3. An applicant has a right of access and correction with respect to his/her personal data as provided under the Personal Data (Privacy) Ordinance (Cap. 486). Request for personal data access and correction should be addressed to the Secretary of the Board at 15/F, North Point Government Offices, 333 Java Road, North Point, Hong Kong.

根據《個人資料(私隱)條例》(第 486 章)的規定，申請人有權查閱及更正其個人資料。如欲查閱及更正個人資料，應向委員會秘書提出有關要求，其地址為香港北角渣華道 333 號北角政府合署 15 樓。

For Developments involving Columbarium Use, please also complete the following:
如發展涉及靈灰安置用途，請另外填妥以下資料：

Ash interment capacity 骨灰安放容量[@]

Maximum number of sets of ashes that may be interred in the niches
在龕位內最多可安放骨灰的數量

Maximum number of sets of ashes that may be interred other than in niches
在非龕位的範圍內最多可安放骨灰的數量

Total number of niches 龕位總數

Total number of single niches
單人龕位總數

Number of single niches (sold and occupied)
單人龕位數目 (已售並佔用)

Number of single niches (sold but unoccupied)
單人龕位數目 (已售但未佔用)

Number of single niches (residual for sale)
單人龕位數目 (待售)

Total number of double niches
雙人龕位總數

Number of double niches (sold and fully occupied)
雙人龕位數目 (已售並全部佔用)

Number of double niches (sold and partially occupied)
雙人龕位數目 (已售並部分佔用)

Number of double niches (sold but unoccupied)
雙人龕位數目 (已售但未佔用)

Number of double niches (residual for sale)
雙人龕位數目 (待售)

Total no. of niches other than single or double niches (please specify type)
除單人及雙人龕位外的其他龕位總數 (請列明類別)

Number of niches (sold and fully occupied)
龕位數目 (已售並全部佔用)

Number of niches (sold and partially occupied)
龕位數目 (已售並部分佔用)

Number of niches (sold but unoccupied)
龕位數目 (已售但未佔用)

Number of niches (residual for sale)
龕位數目 (待售)

Proposed operating hours 擬議營運時間

[@] Ash interment capacity in relation to a columbarium means –
就靈灰安置所而言，骨灰安放容量指：

- the maximum number of containers of ashes that may be interred in each niche in the columbarium;
每個龕位內可安放的骨灰容器的最高數目；
- the maximum number of sets of ashes that may be interred other than in niches in any area in the columbarium; and
在該靈灰安置所並非龕位的範圍內，總共最多可安放多少份骨灰；以及
- the total number of sets of ashes that may be interred in the columbarium.
在該骨灰安置所內，總共最多可安放多少份骨灰。

Gist of Application 申請摘要

(Please provide details in both English and Chinese as far as possible. This part will be circulated to relevant consultees, uploaded to the Town Planning Board's Website for browsing and free downloading by the public and available at the Planning Enquiry Counters of the Planning Department for general information.)

(請盡量以英文及中文填寫。此部分將會發送予相關諮詢人士、上載至城市規劃委員會網頁供公眾免費瀏覽及下載及於規劃署規劃資料查詢處供一般參閱。)

Application No. 申請編號	(For Official Use Only) (請勿填寫此欄)		
Location/address 位置/地址	Lot 2309 S.A (Part) in D.D. 118, Tai Tong, Yuen Long		
Site area 地盤面積	245	sq. m 平方米	<input checked="" type="checkbox"/> About 約
	(includes Government land of 包括政府土地	NA 不適用	sq. m 平方米 <input type="checkbox"/> About 約)
Plan 圖則	大棠分區計劃大綱核准圖編號 S/YL-TT/20 APPROVED TAI TONG OUTLINE ZONING PLAN NO. S/YL-TT/20		
Zoning 地帶	「農業」 "Agriculture"		
Applied use/ development 申請用途/發展	擬議臨時康體文娛場所(休閒農場)連附屬設施及相關填土工程(為期5年) Proposed Temporary Place of Recreation, Sports or Culture (Hobby Farm) with Ancillary Facilities and Associated Filling of Land for a period of 5 years		
(i) Gross floor area and/or plot ratio 總樓面面積及/或地積比率		sq.m 平方米	Plot Ratio 地積比率
	Domestic 住用	NA 不適用	<input type="checkbox"/> About 約 <input type="checkbox"/> Not more than 不多於
	Non-domestic 非住用	38.4	<input checked="" type="checkbox"/> About 約 <input type="checkbox"/> Not more than 不多於
(ii) No. of blocks 幢數	Domestic 住用	NA 不適用	
	Non-domestic 非住用	1	
	Composite 綜合用途	NA 不適用	

(iii) Building height/No. of storeys 建築物高度/層數	Domestic 住用	NA 不適用	m 米 <input type="checkbox"/> (Not more than 不多於)
		NA 不適用	mPD 米(主水平基準上) <input type="checkbox"/> (Not more than 不多於)
		NA 不適用	Storeys(s) 層 <input type="checkbox"/> (Not more than 不多於) (<input type="checkbox"/> Include 包括/ <input type="checkbox"/> Exclude 不包括 <input type="checkbox"/> Carport 停車間 <input type="checkbox"/> Basement 地庫 <input type="checkbox"/> Refuge Floor 防火層 <input type="checkbox"/> Podium 平台)
	Non-domestic 非住用	7	m 米 <input checked="" type="checkbox"/> (Not more than 不多於)
		NA 不適用	mPD 米(主水平基準上) <input type="checkbox"/> (Not more than 不多於)
		2	Storeys(s) 層 <input type="checkbox"/> (Not more than 不多於) (<input type="checkbox"/> Include 包括/ <input type="checkbox"/> Exclude 不包括 <input type="checkbox"/> Carport 停車間 <input type="checkbox"/> Basement 地庫 <input type="checkbox"/> Refuge Floor 防火層 <input type="checkbox"/> Podium 平台)
	Composite 綜合用途	NA 不適用	m 米 <input type="checkbox"/> (Not more than 不多於)
		NA 不適用	mPD 米(主水平基準上) <input type="checkbox"/> (Not more than 不多於)
		NA 不適用	Storeys(s) 層 <input type="checkbox"/> (Not more than 不多於) (<input type="checkbox"/> Include 包括/ <input type="checkbox"/> Exclude 不包括 <input type="checkbox"/> Carport 停車間 <input type="checkbox"/> Basement 地庫 <input type="checkbox"/> Refuge Floor 防火層 <input type="checkbox"/> Podium 平台)
(iv) Site coverage 上蓋面積	7.8	% <input checked="" type="checkbox"/> About 約	
(v) No. of units 單位數目	NA 不適用		
(vi) Open space 休憩用地	Private 私人	NA 不適用	sq.m 平方米 <input type="checkbox"/> Not less than 不少於
	Public 公眾	NA 不適用	sq.m 平方米 <input type="checkbox"/> Not less than 不少於

(vii) No. of parking spaces and loading / unloading spaces 停車位及上落客貨車位數目	Total no. of vehicle parking spaces 停車位總數 Private Car Parking Spaces 私家車車位 Motorcycle Parking Spaces 電單車車位 Light Goods Vehicle Parking Spaces 輕型貨車泊車位 Medium Goods Vehicle Parking Spaces 中型貨車泊車位 Heavy Goods Vehicle Parking Spaces 重型貨車泊車位 Others (Please Specify) 其他 (請列明) _____	1 PC:1
	Total no. of vehicle loading/unloading bays/lay-bys 上落客貨車位/停車處總數 Taxi Spaces 的士車位 Coach Spaces 旅遊巴車位 Light Goods Vehicle Spaces 輕型貨車車位 Medium Goods Vehicle Spaces 中型貨車車位 Heavy Goods Vehicle Spaces 重型貨車車位 Others (Please Specify) 其他 (請列明) _____	

Submitted Plans, Drawings and Documents 提交的圖則、繪圖及文件

	<u>Chinese</u> 中文	<u>English</u> 英文
<u>Plans and Drawings 圖則及繪圖</u>		
Master layout plan(s)/Layout plan(s) 總綱發展藍圖/布局設計圖	<input type="checkbox"/>	<input checked="" type="checkbox"/>
Block plan(s) 樓宇位置圖	<input type="checkbox"/>	<input type="checkbox"/>
Floor plan(s) 樓宇平面圖	<input type="checkbox"/>	<input type="checkbox"/>
Sectional plan(s) 截視圖	<input type="checkbox"/>	<input type="checkbox"/>
Elevation(s) 立視圖	<input type="checkbox"/>	<input type="checkbox"/>
Photomontage(s) showing the proposed development 顯示擬議發展的合成照片	<input type="checkbox"/>	<input type="checkbox"/>
Master landscape plan(s)/Landscape plan(s) 園境設計總圖/園境設計圖	<input type="checkbox"/>	<input type="checkbox"/>
Others (please specify) 其他 (請註明)	<input type="checkbox"/>	<input checked="" type="checkbox"/>
Location Plan, Existing Vehicular Access and Paved Area		
Public Transport, Stream Set Back Area, Water Main Plan, Vehicle Maneuvering Plan		
<u>Reports 報告書</u>		
Planning Statement/Justifications 規劃綱領/理據	<input checked="" type="checkbox"/>	<input checked="" type="checkbox"/>
Environmental assessment (noise, air and/or water pollutions) 環境評估 (噪音、空氣及/或水的污染)	<input type="checkbox"/>	<input type="checkbox"/>
Traffic impact assessment (on vehicles) 就車輛的交通影響評估	<input type="checkbox"/>	<input type="checkbox"/>
Traffic impact assessment (on pedestrians) 就行人的交通影響評估	<input type="checkbox"/>	<input type="checkbox"/>
Visual impact assessment 視覺影響評估	<input type="checkbox"/>	<input type="checkbox"/>
Landscape impact assessment 景觀影響評估	<input type="checkbox"/>	<input type="checkbox"/>
Tree Survey 樹木調查	<input type="checkbox"/>	<input type="checkbox"/>
Geotechnical impact assessment 土力影響評估	<input type="checkbox"/>	<input type="checkbox"/>
Drainage impact assessment 排水影響評估	<input type="checkbox"/>	<input type="checkbox"/>
Sewerage impact assessment 排污影響評估	<input type="checkbox"/>	<input type="checkbox"/>
Risk Assessment 風險評估	<input type="checkbox"/>	<input type="checkbox"/>
Others (please specify) 其他 (請註明)	<input type="checkbox"/>	<input type="checkbox"/>

Note: May insert more than one 「✓」. 註：可在多於一個方格內加上「✓」號

Note: The information in the Gist of Application above is provided by the applicant for easy reference of the general public. Under no circumstances will the Town Planning Board accept any liabilities for the use of the information nor any inaccuracies or discrepancies of the information provided. In case of doubt, reference should always be made to the submission of the applicant.

註：上述申請摘要的資料是由申請人提供以方便市民大眾參考。對於所載資料在使用上的問題及文義上的歧異，城市規劃委員會概不負責。若有任何疑問，應查閱申請人提交的文件。

此為空白頁。

This is a blank page.

Planning Statement

1. Background

The applicant seeks planning permission from the Town Planning Board (the Board) to use Lot 2309 S.A (Part) in D.D. 118, Tai Tong, Yuen Long, New Territories (the application site) for 'Proposed Temporary Place of Recreation, Sports or Culture (Hobby Farm) with Ancillary Facilities and Associated Filling of Land for a Period of 5 Years' (the proposed development).

The Site currently vacant and partly covered in wild grass and partly covered in concrete.

2. Planning Context

The Site currently falls within an area zoned as "Agriculture" ("AGR") on the Approved Tai Tong Outline Zoning Plan (OZP) No.: S/YL-TT/20. According to the Notes of the OZP, the applied use is a column two use within the "AGR" zone, which requires planning permission from the Board with or without conditions on application. The proposed development with low-rise structures is considered not incompatible with the surrounding areas. Therefore, approval of the current application on a temporary basis of 5 years would better utilize agricultural land and would not jeopardize the long-term planning intention of the "AGR" zone.

3. Development Proposal

The site occupies an area of 245 m² (about) (Appendix 2). The structure is provided at the Site for farm reception and ancillary storage of farming tools and documents with total GFA of 38.4 m² (about). Ancillary facilities (i.e. farm reception and ancillary storage) are intended to support the daily operation of the Site. The operation hours of the Site are Mondays to Sundays from 08:00 to 18:00 daily, including public holidays. The number of staff working at the Site is 1. It is anticipated that the Site would be able to attract about 4-6 visitors, from Monday to Friday. On Saturdays and Sundays, it will accommodate around 8-10 visitors per day. Details of development parameters are shown at Table 1 below:

Table 1 – Major Development Parameters

Application Site Area	245 m ² (About)
Covered Area	19.2 m ² (About)
Uncovered Area	225.8 m ² (About)
Plot Ratio	0.16 (About)
Site Coverage	7.8% (About)
Number of Structure	1
Total GFA	38.4 m ² (About)

Proposed Temporary Place of Recreation, Sports or Culture (Hobby Farm) with Ancillary Facilities and Associated Filling of Land for a Period of 5 Years in "Agriculture" Zone, Lot 2309 S.A (Part) in D.D. 118, Tai Tong, Yuen Long, New Territories

Building Height	Not Exceeding 7m
No. of Storey	2

The Application Site is partly covered with grass and partly covered with concrete of not more than 0.2 m in depth. The current application serves to regularise the existing hard-paving of concrete, where the existing levels is +25.8 mPD, which is about 67.3 m² (About 27% of the Application site area) and about 8.7 m² (About 4% of the Application site area) will be added on this planning application (Appendix 4). The filling of land is to facilitate a flat surface for site formation of structures, circulation space and vehicle parking spaces uses. Hence, the hard-paving is considered necessary and has been kept to minimal for the operation of the proposed development. The applicant will strictly follow the proposed scheme during the planning approval period.

The Application Site is accessible from Tai Shue Ha Road East and a local track. 1 parking space for private cars (PC) is provided at the Application Site for staff/customer parking and transportation of goods use. Advance booking is required to access the Application Site for visitors: this is intended to regulate the number of visitors and vehicles at the Application Site to avoid affecting the public and surrounding environment. Staff will be deployed by the applicant to direct vehicles entering/exiting the Site to ensure pedestrian safety to/from the Site. Sufficient space is provided for vehicles to smoothly maneuver within the Site to ensure that no vehicle will turn back onto the local access (Appendix 3). Details of parking provision are shown at Table 2 below:

Table 2 – Parking Provision

Type of Space(s)	No. of Space(s)
Parking space for Private Car (PC) - 2.5m (W) x 5 m (L)	1

Only Private Cars are allowed to enter/exit the Application Site at any time during the planning approval period. No light, medium or heavy goods vehicles exceeding 5.5 tonnes, including container tractors/trailers, as defined in the Road Traffic Ordinance, are allowed to enter/exit the Application Site. The trip generation and attraction rates are as shown at Table 3 below.

Table 3 – Trip Generation and Attraction of the Proposed Development

Time Period	PC		2-Way Total
	In	Out	
Trips at 7:00-11:59	1	1	2
Trips at 12:00-23:59	1	1	2
Trips at 00:00-06:59	0	0	0

Proposed Temporary Place of Recreation, Sports or Culture (Hobby Farm) with Ancillary Facilities and Associated Filling of Land for a Period of 5 Years in "Agriculture" Zone, Lot 2309 S.A (Part) in D.D. 118, Tai Tong, Yuen Long, New Territories

Relevant environmental protection/pollution control ordinances, i.e. Water Pollution Control Ordinance, Air Pollution Control Ordinance, Noise Control Ordinance etc. will be strictly complied with during the planning approval period.

4. Conclusion

The proposed development will not create significant nuisance to the surrounding areas. Adequate mitigation measures will be provided by the applicant, i.e. the submission of FSIs proposal and the drainage proposal for the Planning Application to mitigate any adverse impact arising from the proposed development.

In view of the above, the Board is hereby respectfully recommended to approve the subject application for 'Temporary Place of Recreation, Sports or Culture (Hobby Farm) with Ancillary Facilities and Associated Filling of Land for a Period of 5 Years'.

補充文件

漁農自然護理署

本申請主要耕種大眾化及比較不受氣候影響的蔬果，例如蕃茄等。申請主要提供土地及空間讓比較少接觸郊區及農業的人士明白相關概念及實際困難。

如果耕種有成果，會讓耕種人士取回自己的蔬果。本申請預計在星期一至五會同時接待 1 個家庭，約 4-6 人，星期六、日約有 8-10 人，一日會進行兩組的活動。

申請暫時計劃安排 1 位員工在場接待參加人士及進行耕種。

申請包括平整約 245 平方米，當中已有約 50.8 平方米使用混凝土平整，希望透過規劃申請進行規範。另外，會有額外約 25.2 平方米以混凝土平整的地方會用停泊車輛、車輛轉動空間及興建構築物。其餘約 169 平方米不會平整，以便耕種。

計劃在 Reception 內提供空間更換及儲存參加人士的私人物品及衣服，當參加人士準備後便會進行有關耕種的講解及下田，耕種期間會讓參加人士自行影相留念，申請範圍不會進行大型活動，以免影響附近地方及居民。

由於較少人流，講解工作能夠在平整的地方及安靜的環境進行，因此不會使用任何擴音裝置。講解後才會下田耕種，減低土壤污染及提高成功耕種的機會。相信這些活動及少量的人流不會影響土壤及在附近棲息的動物，也不會對此區的規劃意向帶來長遠或產生偏差的影響。

希望此附加文件能釋除 貴署的隱憂，並支持本申請。

地政總署

收悉 貴署根據丈量約份第 118 約地段第 2309 S.A 號的現場違例建築物，並知悉 貴署的密切關注。當申請獲批會向 貴署短期豁免書，並會遵從 貴署所批出短期豁免書內例明的條款。我們已知觸犯上述條例的嚴重性，並會盡快糾正及申請短期豁免書。申請範圍內亦只會興建臨時建築物，符合 貴署要求。

希望此附加文件能釋除 貴署的隱憂，並支持本申請。

渠務署

本申請會以保護河道為重點，務求不會影響附近的河道。申請範圍的北面雖然進入緩衝區 3 米內的距離，但該範圍不會進行任何發展，會繼續以農業用途使用。

3 米緩衝區請參考 Appendix 7。

希望此附加文件能釋除 貴署的隱憂，並支持本申請。

水務署

本人了解本申請有機會影響現有的供水設施，如需要更改供水設施時，本人必定會提供一切幫助，亦同意水務署的職員或其外判工程人員隨時進出本申請範圍，以便 貴署進行供水相關的工程。

本人亦了解如未能更改該水掣位置或其設計，會預留與水掣的中心線不小於 1.5 米的空間，以便 貴署進行相關的工程。詳細請參考 Drawing 8。

此申請範圍內不會進行栽種任何含有入侵式根部的樹木 (Tree or shrubs with penetrating roots)，以免影響供水設施。

本人了解政府無需為任何因供水設施滲漏或損毀而導致的損失而付上任何責任。

希望此附加文件能釋除 貴署的隱憂，並支持本申請。

運輸署

出入本申請地點主要使用大樹下東路，該道路為一條雙線雙程的道路，並備有避車處，之後轉到郊區小徑。

預計本申請地點的車流為以下：

時段	私家車		輕型貨車		中型貨車		重型貨車		進出 總和
	進	出	進	出	進	出	進	出	
早上時段(7:00-11:59)	1	1	0	0	0	0	0	0	2
下午時段(12:00- 23:59)	1	1	0	0	0	0	0	0	2
凌晨時段(0:00-06:59)	0	0	0	0	0	0	0	0	0

現申請 1 個私家車停車位。該私家車位置為員工及訪客車位，以便上落耕種用具及其他所需用品。訪客需以有效方式(例如電話)向申請人預約使用該停車位，不接受未有預約的車輛使用。申請人計劃聘請附近居住的員工處理日常事務，因此上述的私家車停車位已足夠此申請運作。

申請地點有道路連接，前往本申請地點途經大樹下東路，再轉到郊區小徑到達申請地點。大樹下東路沿途道路約有 6 米闊，並設有避車處。私家車有足夠的位置通過及進行調遣的動作。申請地點的出入口約 4.5 米闊。

連接本申請地點的郊區小徑約 950 米長，約有 3-6 米闊，並設有避車處。

在申請地點內有足夠空間讓車輛進行調遣的動作，進入本申請地點的車輛不會在公用道路上讓車輛等候進入本申請地點，停泊在公用道路及以倒後形式進出本申請地點。參考文件末端的 Appendix 5。

申請人建議參與人士使用公共交通工具前往本申請地點，申請地點可透過綠色公共小巴路線 73 及 73A 線能到達申請地點出入口外約 150 米。少量的訪客及車流量不會對道路及公共交通流量造成負面影響。位置請參考文件末端的 Appendix 6。

申請人明白及了解連接申請地點的道路不是由 貴署管理。

希望此附加文件能釋除 貴署的隱憂，並支持本申請。

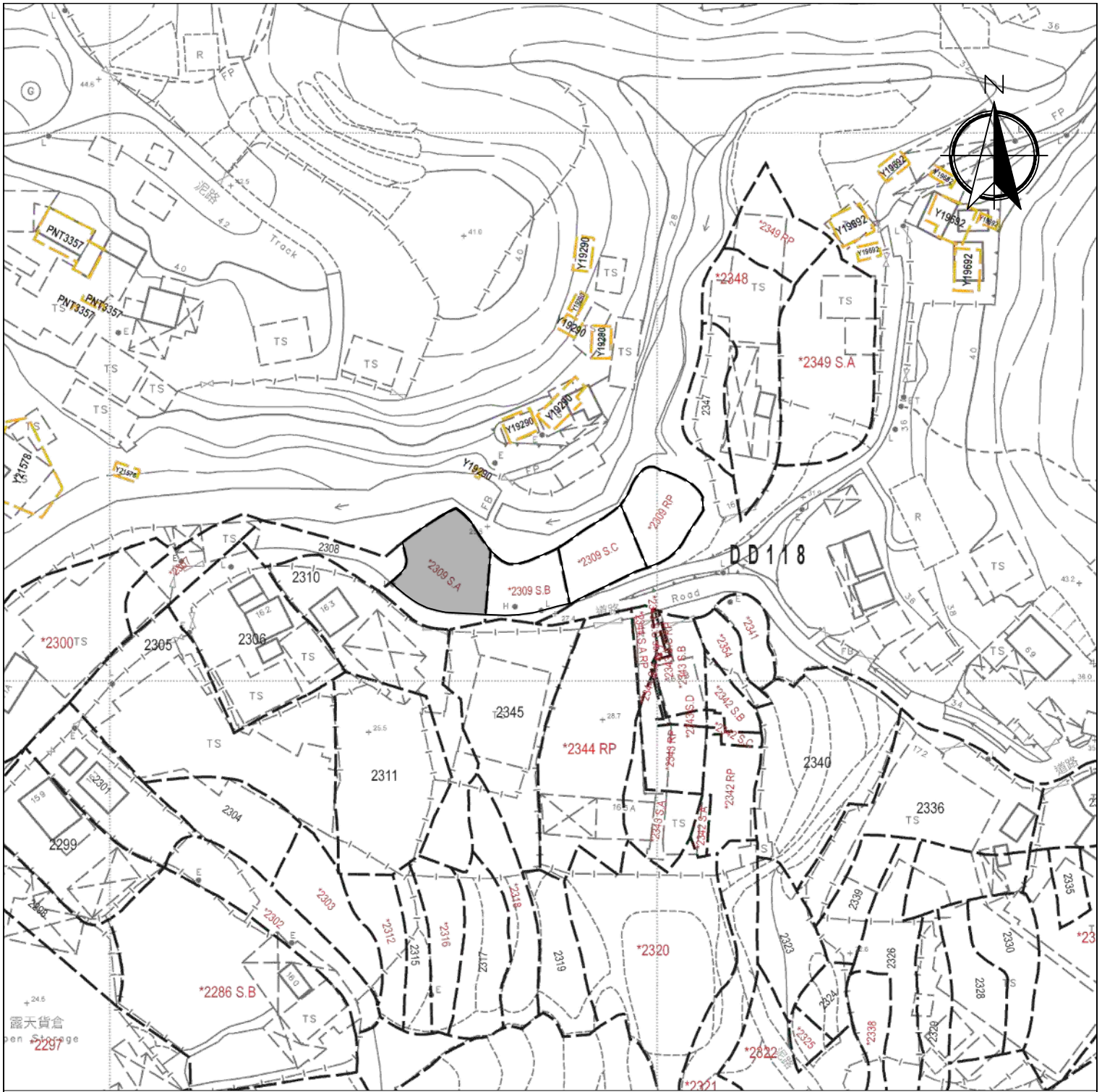

Legend:

Application Site 申請範圍

<p><u>Appendix 1</u></p>		<p><u>Application Location</u></p> <p>申請位置圖</p>		<p><u>SCALE</u></p>	
Location:	DD 118 Lot 2309 S.A (Part)	<p>擬議臨時康體文娛場所 (休閒農場)</p> <p>連附屬設施及相關填土工程</p> <p>(為期5年)</p>		<p>1:1000</p>	
OZP:	S/YL-TT/20	<p>Proposed Temporary Place of Recreation, Sports or Culture (Hobby Farm) with Ancillary Facilities and Associated Filling of Land For a Period of 5 Years</p>		<p>@A4</p>	
District:	Tai Tong			<p>For Identification Only</p>	
Zoning:	Agriculture				
Date:	2 March 2026			<p>Drawing No.: 1-01</p>	

Proposed Structures Details

	Structures	Gross Floor Area (GFA)	Height (Not Exceeding)	Storey	Unit(s)
1	G/F: Farm Reception	About 6m x 3.2m = 19.2 m ²	7m	2	1
	U/F: Ancillary Storage	About 6m x 3.2m = 19.2 m ²			
	Total	<u>About 38.4 m²</u>			
	Private Car Parking Space	5m x 2.5m			1

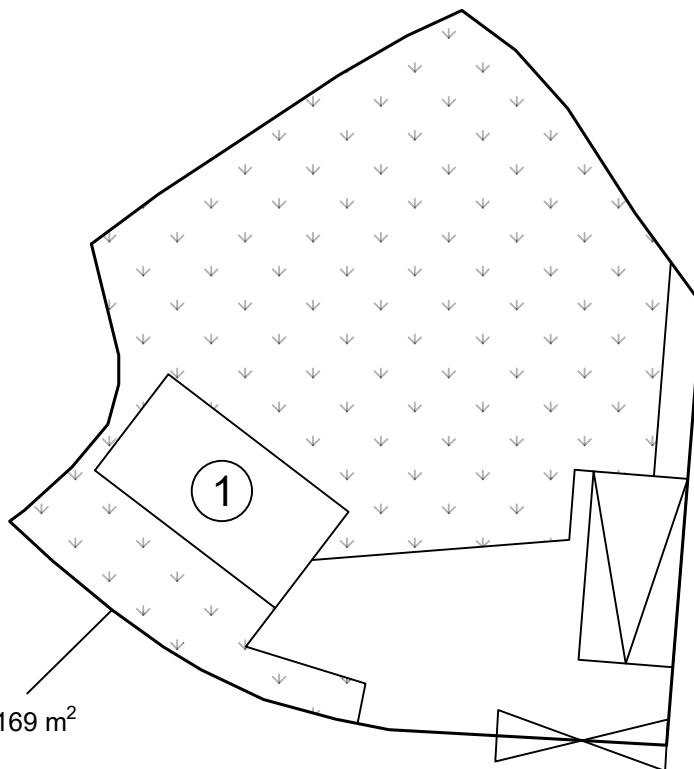

Farming Area: About 169 m²

Farming Area: About 169 m² (About 69% of Total Area)

Legend:

⊞ Ingress/egress (Width: About 4.5m)

⊞ Proposed Structures

⊞ Private Car Parking Space

⊞ Farming Area

① Farm Reception and Storage

Total Area: 245 m² (About)

Covered Area: 19.2 m² (About)

Uncovered Area: 225.8 m² (About)

Non-Domestic GFA: 38.4 m² (About)

Nos. of Proposed Structures: 1

Appendix 2

Location: DD 118 Lot 2309 S.A (Part)

OZP: S/YL-TT/20
District: Tai Tong
Zoning: Agriculture

Date: 9 March 2026

Proposed Layout Plan

擬議佈局平面圖

擬議臨時康體文娛場所 (休閒農場)
連附屬設施及相關填土工程
(為期5年)

Proposed Temporary Place of Recreation, Sports or Culture (Hobby Farm) with Ancillary Facilities and Associated Filling of Land For a Period of 5 Years

SCALE

1:200

@A4

For Identification Only

Drawing No.:

2-01

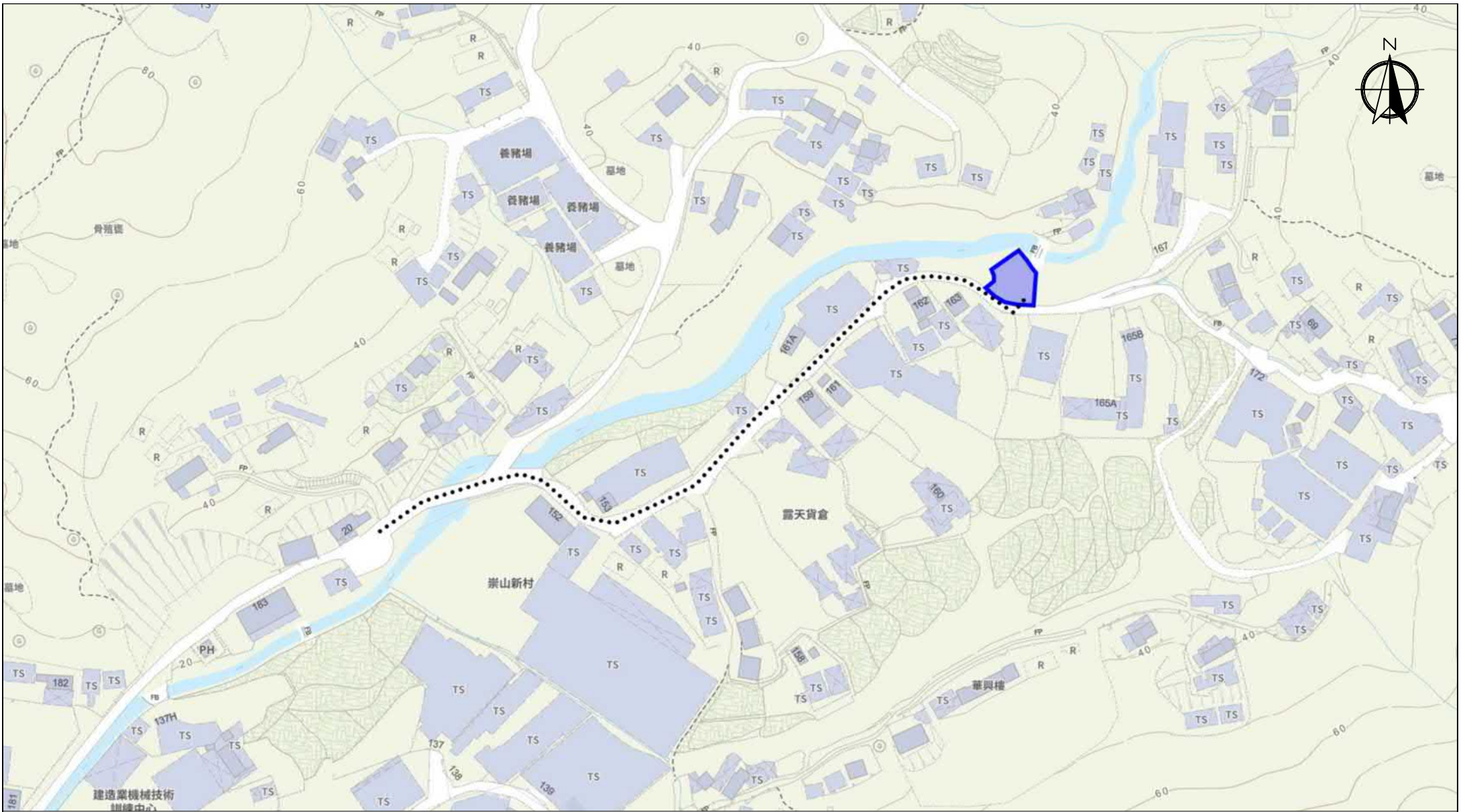

Scale: Undefined @A4

Captured from map.gov.hk on 14th November 2025

<p>Appendix 3 Existing Vehicular Access</p>	<p>Location: D.D. 118 Lot 2309 S.A (Part) OZP: S/YL-TT/20 District: Tai Tong Zoning: Agriculture</p>	<p>Project: Proposed Temporary Place of Recreation, Sports or Culture (Hobby Farm) with Ancillary Facilities and Associated Filling of Land For a Period of 5 Years</p>	<p>Width of Tai Shue Ha Road East: 6m (About) with passing space Map Legend: ●●●●● Road Path — Site Boundary</p>	<p>Drawing No.: 3-01 For Identification Only Date: 14/11/2025</p>
--	--	--	--	---

Proposed Filling of Land Perimeter

Application Site Area: 245 m² (About)
 Proposed Land Filling Area: 76 m² (About)
 Depth of Land Filling: About 0.2 m
 Original Site Levels: +25.6 mPD (About)
 Proposed Site Levels: +25.8 mPD (About)
 Material of Filling: Concrete
 Proposed Use: Structures building, Car Parking and Circulation Space



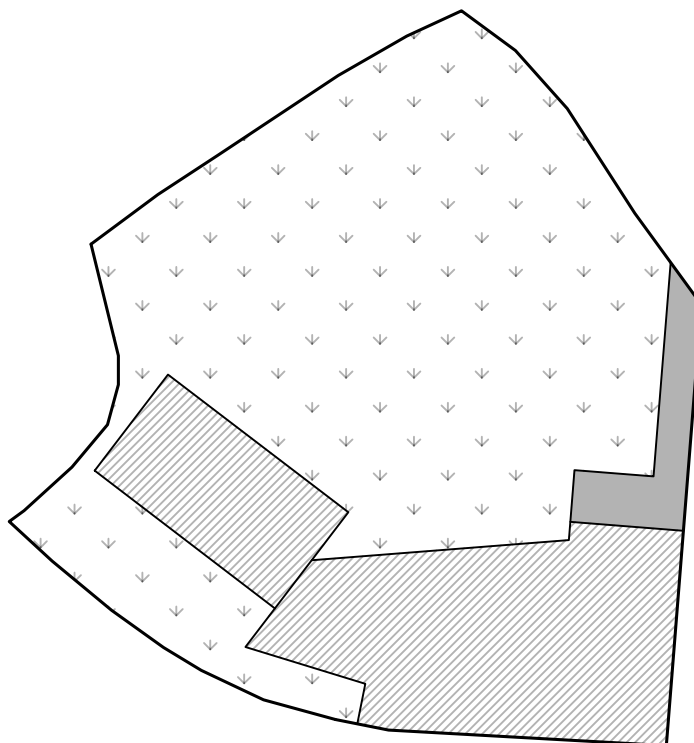

Pave Ratio

Farm Area (Non-Paved Area): About 169 m² (About 69%)
 Paved with Concrete (regularized area): About 67.3 m² (About 27%)
 Will be paved with Concrete Area: About 8.7 m² (About 4%)



Legend:

-  Paved with Concrete Area
-  Non-Paved Area
-  Will be paved with Concrete Area

Appendix 4

Location: DD 118 Lot 2309 S.A (Part)

OZP: S/YL-TT/20
 District: Tai Tong
 Zoning: Agriculture

Date: 2 March 2026

Filling of Land Plan

擬議臨時康體文娛場所 (休閒農場)
 連附屬設施及相關填土工程
 (為期5年)

Proposed Temporary Place of Recreation, Sports or Culture (Hobby Farm) with Ancillary Facilities and Associated Filling of Land For a Period of 5 Years

SCALE

1:200

@A4

For Identification Only

Drawing No.:

4-01

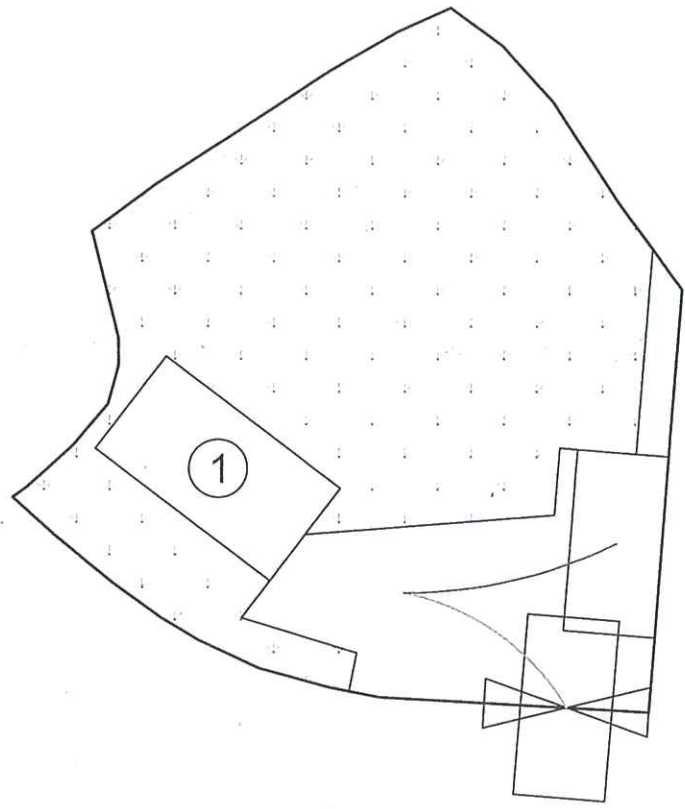

Legend:

- Ingress/egress (Width: About 4.5m)
- Proposed Structures
- Private Car Parking Space
- ① Farm Reception and Storage

<p>Appendix 5</p> <p>Location: DD 118 Lot 2309 S.A (Part)</p> <p>OZP: S/YL-TT/20</p> <p>District: Tai Tong</p> <p>Zoning: Agriculture</p> <p>Date: 2 March 2026</p>	<p><u>Vehicle Maneuvering Plan</u></p> <p>擬議臨時康體文娛場所 (休閒農場) 連附屬設施及相關填土工程 (為期5年)</p> <p>Proposed Temporary Place of Recreation, Sports or Culture (Hobby Farm) with Ancillary Facilities and Associated Filling of Land For a Period of 5 Years</p>	<p><u>SCALE</u></p> <p>1:200</p> <p>@A4</p>	<p>Drawing No.:</p> <p>5</p>
		<p>For Identification Only</p>	

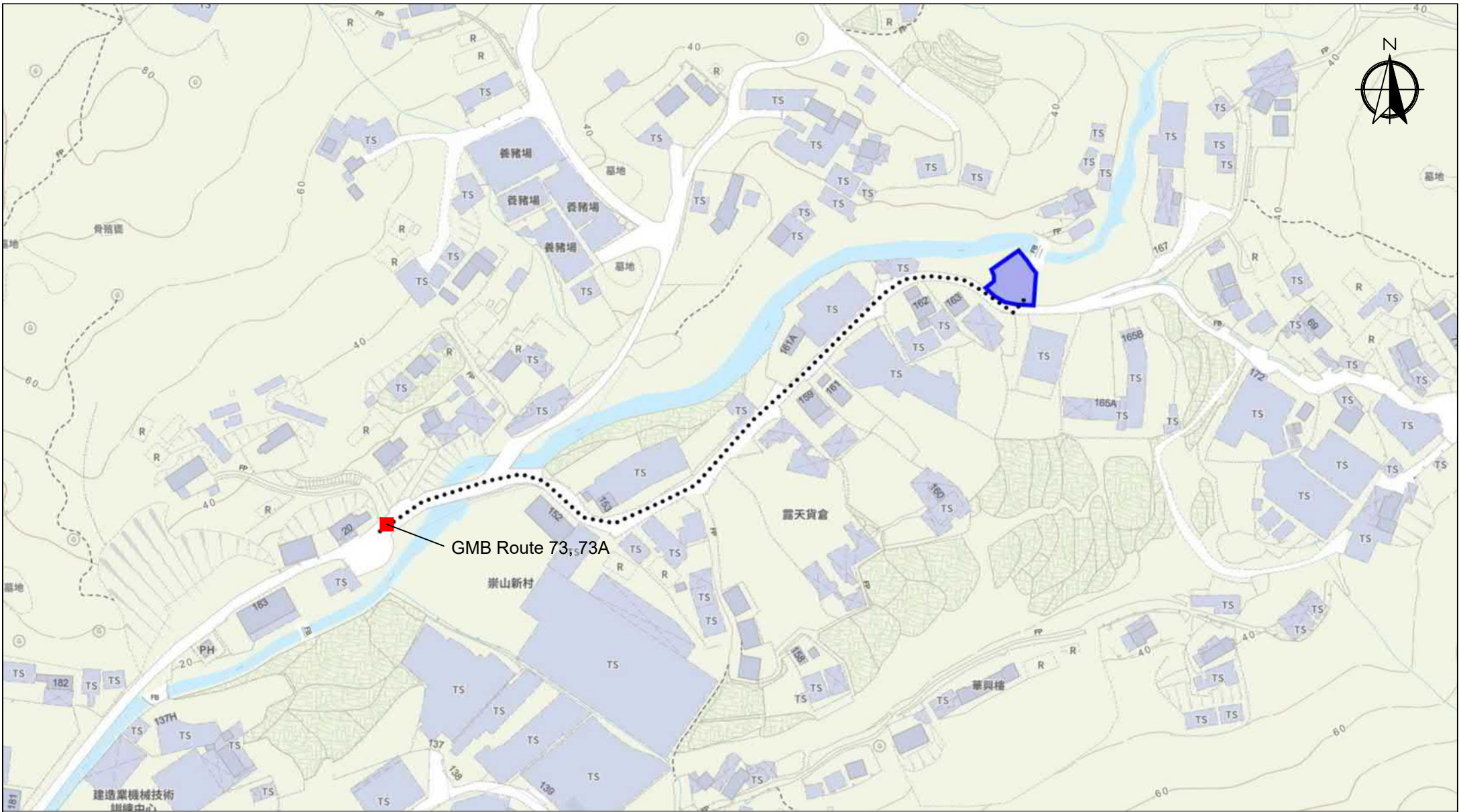

GMB Route 73, 73A

Scale: Undefined @A4

Captured from map.gov.hk on 14th November 2025

<p>Appendix 6 Public Transport</p>	<p>Location: D.D. 118 Lot 2309 S.A (Part) OZP: S/YL-TT/20 District: Tai Tong Zoning: Agriculture</p>	<p>Project: Proposed Temporary Place of Recreation, Sports or Culture (Hobby Farm) with Ancillary Facilities and Associated Filling of Land For a Period of 5 Years</p>	<p>Width of Tai Shue Ha Road East: 6m (About) with passing space Map Legend: ●●●●● Road Path — Site Boundary</p>	<p>Drawing No.: 3-01 For Identification Only Date: 04/02/2026</p>

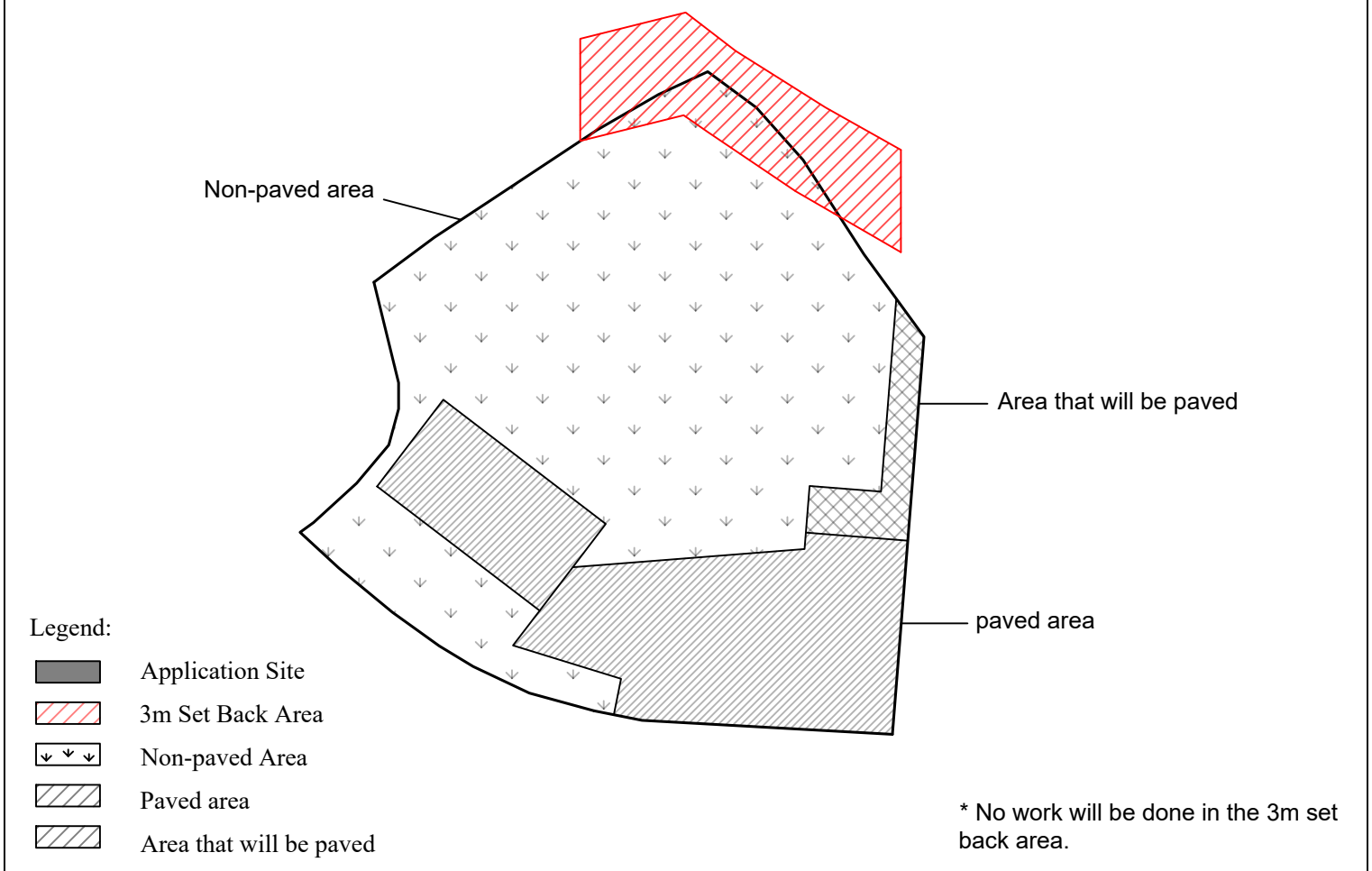
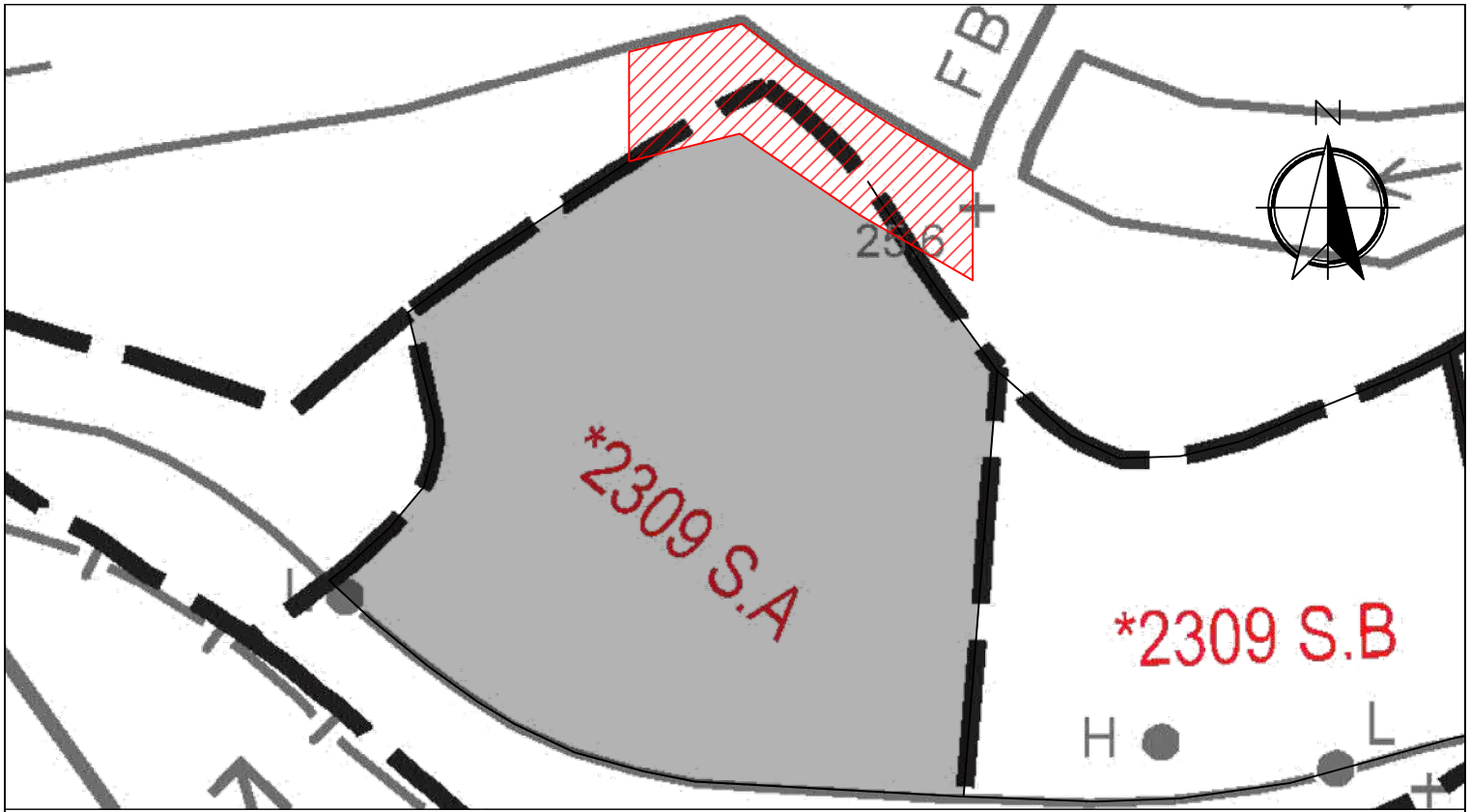



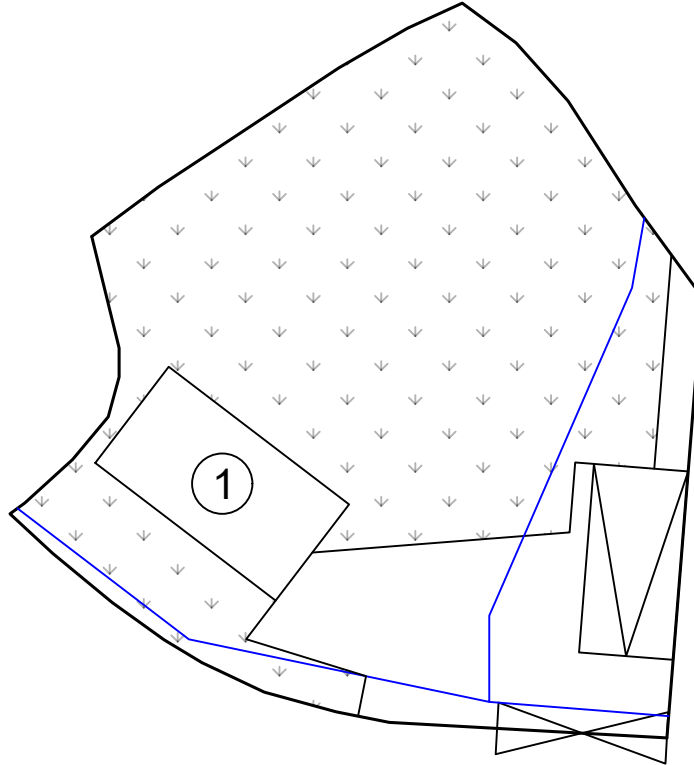

<u>Appendix 7</u>		<u>Stream Set Back Area</u>		<u>SCALE</u>	
Location:	DD 118 Lot 2309 S.A (Part)	擬議臨時康體文娛場所 (休閒農場) 連附屬設施及相關填土工程 (為期5年) Proposed Temporary Place of Recreation, Sports or Culture (Hobby Farm) with Ancillary Facilities and Associated Filling of Land For a Period of 5 Years		1:200	Drawing No.:
OZP:	S/YL-TT/20			@A4	
District:	Tai Tong				
Zoning:	Agriculture			For Identification Only	
Date:	9 March 2026				7



* 1.5m reserves has been provided for WSD to carry out relevant work.

Legend:

-  Farming Area
-  Proposed Structure
-  Private Car Parking Space
-  Water Main

<p><u>Appendix 8</u></p> <p>Location: DD 118 Lot 2309 S.A (Part)</p> <p>OZP: S/YL-TT/20</p> <p>District: Tai Tong</p> <p>Zoning: Agriculture</p> <p>Date: 2 March 2026</p>	<p><u>Water Main Plan</u></p> <p>擬議臨時康體文娛場所 (休閒農場) 連附屬設施及相關填土工程 (為期5年)</p> <p>Proposed Temporary Place of Recreation, Sports or Culture (Hobby Farm) with Ancillary Facilities and Associated Filling of Land For a Period of 5 Years</p>	<p><u>SCALE</u></p> <p>1:200</p> <p>@A4</p>
		<p>For Identification Only</p>
		<p>Drawing No.: 8</p>